

The information provided herein is from CONNPLY Electronic Co., Ltd. and is confidential. Any disclosure to a party other than the recipient is prohibited. The intellectual properties and its rights are strictly reserved. All intellectual properties provided herein are for reference purposes only and does not constitute authorization of its use in any format or manner. CONNPLY may enforce its intellectual property rights at its own discretion; failures or delays to exercise such rights does not constitute a waiver of such rights.

# Male

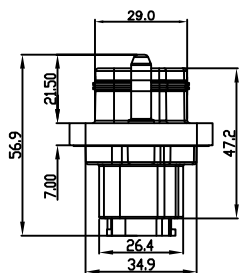

# Female

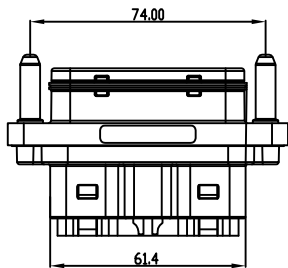
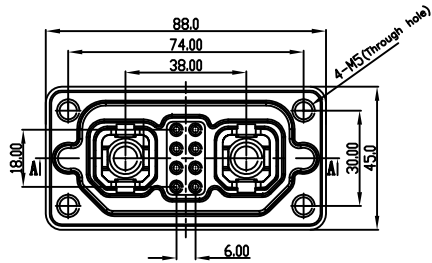
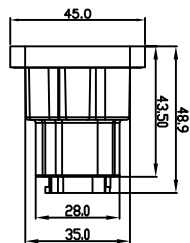
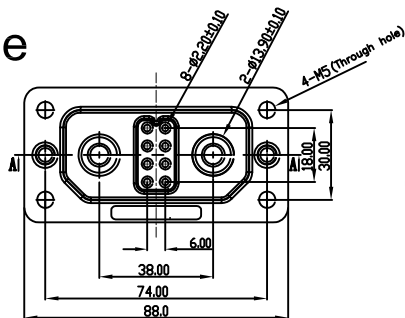

REV.	DESCRIPTION	DRAWN	CHECKED	APPROVED
A	NEW RELEASE	WPY 08/27/25'		

Notes:

1. Rated current:200A
2. Instantaneous current:400A
3. Environmental temperature: -20°C -120°C
4. Mechanical lifespan:1000 cys

Materials:

1. Insulation Material: PA66, UL94V-0
2. Contact material:Red copper

Product Number Code:  
DS1231-02-X X X X X

- Packing Type:  
P:Ploybag
- Housing color:  
B:Black
- Contact Plating  
N:Full Nickel
- Connector type:  
M:Male F:Female  
A:Male+Female
- No. of Contacts  
10:2+8Pin

GENERAL TOLERANCE		ANGLE TOLERANCE		PROJECTION		TITLE	2+8Pin 8mm Stacked Connector	
X.	±0.60	X.	±5°	UNITS	mm	SHEET	A4	
.X	±0.38	.X	±3°	SHEET SIZE	A4	SERIES	DS1231-02 SERIES	
.XX	±0.25	.XX	±2°	<b>晨翔电子有限公司</b> <b>CONNPLY CONNPLY ELECTRONIC CO. LTD</b>				
DRAWING TYPE		CUSTOMER						
SCALE		1:1	SHEET 1 OF 1					
DRAWING NO.		C-DS1231-02-XXXXX-A						