

The information provided herein is from CONNELY Electronic Co., Ltd. and is confidential. Any disclosure to a party other than the recipient is prohibited. The intellectual properties and its rights contained herein, including but not limited to, trademarks, patents, copyrights, trade secrets, and technical know-how, are owned exclusively by CONNELY or its affiliates. Unauthorized use of this information in any format or manner. CONNELY may enforce its intellectual property rights at its own discretion; failures or delays to exercise such rights does not constitute a waiver of such rights.

Male

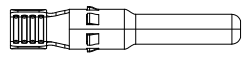

Stamping Pin

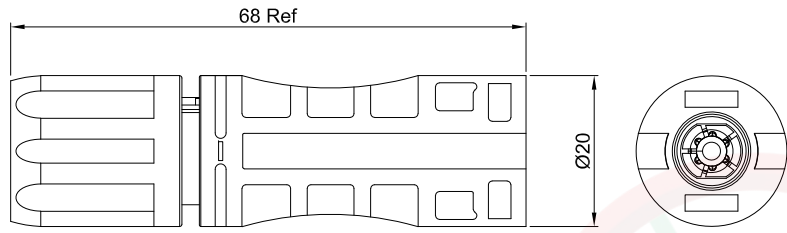
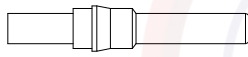

Machine Pin

Female

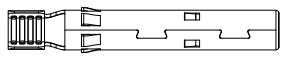
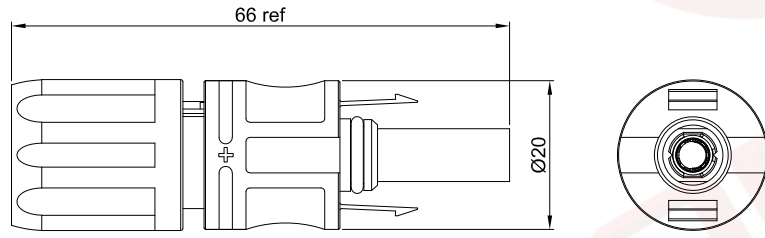

Stamping Pin



Machine Pin



(Series Image-Reference Only)

REV.	DESCRIPTION	DRAWN	CHECKED	APPROVED
A	NEW RELEASE	JLZ 09/06/23'		

Notes:

Specifications:

1. Contact Resistance: 0.5mΩ Max.
2. Insulation Resistance: 1000MΩ Min.
3. Dielectric Withstanding Voltage: 8000V AC(rms) For 1 Minute.
4. Current Rating: 30A or 50A.
5. Voltage Rating: 1500V DC rms.
6. Temperature: -40°C~+85°C.
7. Cable size: 2.5~10mm².
8. Waterproof rated: IP67.

Materials:

1. Insulating material: Thermoplastic, UL 94 V-0.
2. Contact: Red Copper, Tin plated.
3. Fingers: Beryllium Copper, Tin Plated.
4. Clip: Stainless Steel.
5. Sealing: Silicone rubber, Black.

Product Number Code:

DS1162-21 - X X X X X X

- Current Type
 - A: 30A(Stamping Pin)
 - B: 50A(Machine Pin)
- Packing Type
 - 1: Mix packing(Female+Male/Bag)
 - 2: Separation packing(Female/Bag or Male/Bag)
 - Q:N*Female/Bag+N*Male/Bag+N*Male Contact/Bag +Female Contact/Bag
- Housing color
 - B: Black
- Contact plating
 - 6: Tin
- Mounting type
 - C: Locking type
- Connector type
 - F: Female M: Male
 - A: Female+Male

GENERAL TOLERANCE		ANGLE TOLERANCE	
X.	±0.60	X.	±5°
.X	±0.38	.X	±3°
.XX	±0.25	.XX	±2°

PROJECTION		TITLE	Solar Connectors Wire to Wire
UNITS	mm		W/ Lock Type (1500V)
SHEET SIZE	A4	SERIES	DS1162-21 SERIES

晨翔电子有限公司
CONNFLY CONNELY ELECTRONIC CO. LTD

DRAWING TYPE	CUSTOMER		
SCALE	1:1	SHEET	1 OF 2
DRAWING NO.	C-DS1162-21-XXXXX-A		

The information provided herein is from CONNELY Electronic Co., Ltd. and is confidential. Any disclosure to a party other than the recipient is prohibited. The intellectual properties and its rights contained herein, including but not limited to, trademarks, patents, copyrights, trade secrets, and technical know-how, are owned exclusively by CONNELY or its affiliates. Unauthorized use or reproduction of this document in any format or manner. CONNELY may enforce its intellectual property rights at its own discretion; failures or delays to exercise such rights does not constitute a waiver of such rights.

Male

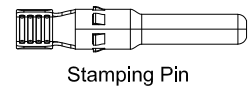
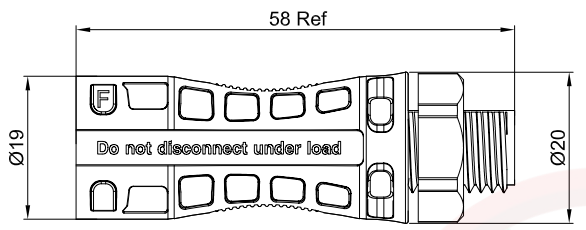

Stamping Pin



Machine Pin

Female

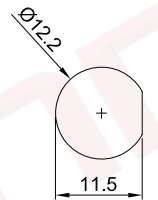
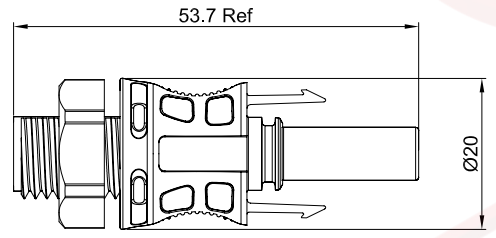

Suggested Panel Opening

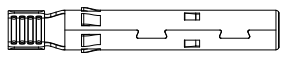

Stamping Pin



Machine Pin



(Series Image-Reference Only)

REV.	DESCRIPTION	DRAWN	CHECKED	APPROVED
A	NEW RELEASE	JLZ 09/06/23'		

Notes:

Specifications:

1. Contact Resistance: 0.5mΩ Max.
2. Insulation Resistance: 1000MΩ Min.
3. Dielectric Withstanding Voltage: 8000V AC(rms) For 1 Minute.
4. Current Rating: 30A or 50A.
5. Voltage Rating: 1500V DC rms.
6. Temperature: -40°C~+85°C.
7. Cable size: 2.5~10mm².
8. Waterproof rated: IP67.

Materials:

1. Insulating material: Thermoplastic, UL 94 V-0.
2. Contact: Red Copper, Tin plated.
3. Fingers: Beryllium Copper, Tin Plated.
4. Clip: Stainless Steel.
5. Sealing: Silicone rubber, Black.

Product Number Code:

DS1162-21 - X X X X X X

- Current Type
 - A: 30A(Stamping Pin)
 - B: 50A(Machine Pin)
- Packing Type
 - 1: Mix packing(Female+Male/Bag)
 - 2: Separation packing(Female/Bag or Male/Bag)
 - Q:N*Female/Bag+N*Male/Bag+N*Male Contact/Bag +Female Contact/Bag
- Housing color
 - B: Black
- Contact plating
 - 6: Tin
- Mounting type
 - V: Panel type
- Connector type
 - F: Female M: Male
 - A: Female+Male

GENERAL TOLERANCE		ANGLE TOLERANCE	
X.	±0.60	X.	±5°
.X	±0.38	.X	±3°
.XX	±0.25	.XX	±2°

PROJECTION	TITLE
	Solar Connectors Wire to Board
UNITS	W/ Lock Type (1500V)
SHEET SIZE	SERIES DS1162-21 SERIES

DRAWING TYPE	CUSTOMER
SCALE	1:1 SHEET 2 OF 2
DRAWING NO.	C-DS1162-21-XXXXX-A

